

# ASM-1000 Series Blades

Used in the following *Schäfer / Megomat* machines:

ASM-1000

Available ASM-1000 Blade Form Geometries Include:



Universal



V-Style

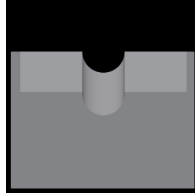

Die-Type

## MG10VU-A Stripping Blades



Mechtrix Description	Mechtrix Part Number	Blade Form Diameter (in)	Diameter (mm)	OEM Part Number
MG10VU-A Stripping Blade	13770	-	-	6.013.0059.400

## MG10VC Cut-off Blades



Mechtrix Description	Mechtrix Part Number	Blade Form Diameter (in)	Diameter (mm)	OEM Part Number
MG10VC-0.8-2.0 Cut-off Blade	13773	-	-	6.013.0062.400
MG10VC-0.4-0.8 Cut-off Blade	13772	-	-	6.013.0061.400
MG10VC-0.2-0.4 Cut-off Blade	13771	-	-	6.013.0060.400

## MG10V V-Style Stripping Blades



Mechtrix Description	Mechtrix Part Number	Blade Form Diameter (in)	Diameter (mm)	OEM Part Number
MG10V-0.6 Stripping Blade	23170	0.02362	0.60	6.013.0092.406
MG10V-0.7 Stripping Blade	23171	0.02756	0.70	6.013.0092.407
MG10V-0.8 Stripping Blade	18189	0.03150	0.80	6.013.0092.408
MG10V-0.9 Stripping Blade	23172	0.03543	0.90	6.013.0092.409
MG10V-1.0 Stripping Blade	14168	0.03937	1.00	6.013.0092.410
MG10V-1.1 Stripping Blade	17386	0.04331	1.10	6.013.0092.411
MG10V-1.2 Stripping Blade	14901	0.04724	1.20	6.013.0092.412
MG10V-1.3 Stripping Blade	15410	0.05118	1.30	6.013.0092.413
MG10V-1.4 Stripping Blade	13742	0.05512	1.40	6.013.0092.414
MG10V-1.5 Stripping Blade	23173	0.05906	1.50	6.013.0092.415
MG10V-1.6 Stripping Blade	14698	0.06299	1.60	6.013.0092.416
MG10V-1.8 Stripping Blade	14902	0.07087	1.80	6.013.0092.418
MG10V-2.0 Stripping Blade	14903	0.07874	2.00	6.013.0092.420
MG10V-2.2 Stripping Blade	14247	0.08661	2.20	6.013.0092.422
MG10V-2.4 Stripping Blade	14248	0.09449	2.40	6.013.0092.424
MG10V-2.6 Stripping Blade	14249	0.10236	2.60	6.013.0092.426
MG10V-2.8 Stripping Blade	13735	0.11024	2.80	6.013.0092.428
MG10V-3.0 Stripping Blade	13959	0.11811	3.00	6.013.0092.430

Continued on Next Page

# ASM-1000 Series Blades

Used in the following *Schäfer / Megomat* machines:

ASM-1000



## MG10V V-Style Stripping Blades

Mechtrix Description	Mechtrix Part Number	Blade Form (in)	Diameter (mm)	OEM Part Number
MG10V-3.2 Stripping Blade	16066	0.12598	3.20	6.013.0092.432
MG10V-3.4 Stripping Blade	15980	0.13386	3.40	6.013.0092.434
MG10V-3.6 Stripping Blade	18846	0.14173	3.60	6.013.0092.436
MG10V-3.8 Stripping Blade	18847	0.14961	3.80	6.013.0092.438
MG10V-4.0 Stripping Blade	18848	0.15748	4.00	6.013.0092.440



## MG10VC V-Style Cut-off Blades

Mechtrix Description	Mechtrix Part Number	Blade Form (in)	Diameter (mm)	OEM Part Number
MG10VC-0.8-2.0 Cut-off Blade	13773	-	-	6.013.0062.400
MG10VC-0.4-0.8 Cut-off Blade	13772	-	-	6.013.0061.400
MG10VC-0.2-0.4 Cut-off Blade	13771	-	-	6.013.0060.400



## MG10D Die-Type Stripping Blades

Mechtrix Description	Mechtrix Part Number	Blade Form (in)	Diameter (mm)	OEM Part Number
MG10D-0.6 Stripping Blade	18812	0.02362	0.60	6.013.0131.406
MG10D-0.7 Stripping Blade	18813	0.02756	0.70	6.013.0131.407
MG10D-0.8 Stripping Blade	18154	0.03150	0.80	6.013.0131.408
MG10D-0.9 Stripping Blade	17108	0.03543	0.90	6.013.0131.409
MG10D-1.0 Stripping Blade	18694	0.03937	1.00	6.013.0131.410
MG10D-1.1 Stripping Blade	17107	0.04331	1.10	6.013.0131.411
MG10D-1.2 Stripping Blade	14764	0.04724	1.20	6.013.0131.412
MG10D-1.3 Stripping Blade	14765	0.05118	1.30	6.013.0131.413
MG10D-1.4 Stripping Blade	15369	0.05512	1.40	6.013.0131.414
MG10D-1.5 Stripping Blade	18814	0.05906	1.50	6.013.0131.415
MG10D-1.6 Stripping Blade	15808	0.06299	1.60	6.013.0131.416
MG10D-1.7 Stripping Blade	15401	0.06693	1.70	6.013.0131.417
MG10D-1.8 Stripping Blade	15842	0.07087	1.80	6.013.0131.418
MG10D-1.9 Stripping Blade	15370	0.07480	1.90	6.013.0131.419
MG10D-2.0 Stripping Blade	17895	0.07874	2.00	6.013.0131.420
MG10D-2.1 Stripping Blade	15671	0.08268	2.10	6.013.0131.421
MG10D-2.2 Stripping Blade	15807	0.08661	2.20	6.013.0131.422
MG10D-2.3 Stripping Blade	18818	0.09055	2.30	6.013.0131.423
MG10D-2.4 Stripping Blade	16184	0.09449	2.40	6.013.0131.424
MG10D-2.5 Stripping Blade	14898	0.09843	2.50	6.013.0131.425
MG10D-2.6 Stripping Blade	16185	0.10236	2.60	6.013.0131.426
MG10D-2.7 Stripping Blade	18823	0.10630	2.70	6.013.0131.427
MG10D-2.8 Stripping Blade	18158	0.11024	2.80	6.013.0131.428

Continued on Next Page

# ASM-1000 Series Blades

Used in the following *Schäfer / Megomat* machines:

ASM-1000



## MG10D Die-Type Stripping Blades

Mechtrix Description	Mechtrix Part Number	Blade Form (in)	Diameter (mm)	OEM Part Number
MG10D-2.9 Stripping Blade	14899	0.11417	2.90	6.013.0131.429
MG10D-3.0 Stripping Blade	18824	0.11811	3.00	6.013.0131.430
MG10D-3.1 Stripping Blade	18825	0.12205	3.10	6.013.0131.431
MG10D-3.2 Stripping Blade	18826	0.12598	3.20	6.013.0131.432
MG10D-3.3 Stripping Blade	18827	0.12992	3.30	6.013.0131.433
MG10D-3.4 Stripping Blade	18828	0.13386	3.40	6.013.0131.434
MG10D-3.5 Stripping Blade	18829	0.13780	3.50	6.013.0131.435
MG10D-3.6 Stripping Blade	18830	0.14173	3.60	6.013.0131.436
MG10D-3.7 Stripping Blade	18831	0.14567	3.70	6.013.0131.437
MG10D-3.8 Stripping Blade	18832	0.14961	3.80	6.013.0131.438
MG10D-3.9 Stripping Blade	18833	0.15354	3.90	6.013.0131.439
MG10D-4.0 Stripping Blade	18834	0.15748	4.00	6.013.0131.440
MG10D-4.1 Stripping Blade	18835	0.16142	4.10	6.013.0131.441
MG10D-4.2 Stripping Blade	18836	0.16535	4.20	6.013.0131.442
MG10D-4.3 Stripping Blade	18837	0.16929	4.30	6.013.0131.443
MG10D-4.4 Stripping Blade	18838	0.17323	4.40	6.013.0131.444
MG10D-4.5 Stripping Blade	18839	0.17717	4.50	6.013.0131.445
MG10D-4.6 Stripping Blade	18840	0.18110	4.60	6.013.0131.446
MG10D-4.7 Stripping Blade	18841	0.18504	4.70	6.013.0131.447
MG10D-4.8 Stripping Blade	18842	0.18898	4.80	6.013.0131.448
MG10D-4.9 Stripping Blade	18843	0.19291	4.90	6.013.0131.449
MG10D-5.0 Stripping Blade	18844	0.19685	5.00	6.013.0131.450



## MG10DC Cut-off Blades

Mechtrix Description	Mechtrix Part Number	Blade Form (in)	Diameter (mm)	OEM Part Number
MG10DC Cut-off Blade	14127	-	-	6.013.0072.400

Continued on Next Page

# ASM-1000 Series Blades

Used in the following *Schäfer / Megomat* machines:

ASM-1000



## MG10DG Wire Guides

Mechtrix Description	Mechtrix Part Number	Guide Form Diameter (in)	Guide Form Diameter (mm)	OEM Part Number
MG10DG-0.6 Wire Guide	23175	0.02362	0.60	6.013.0130.406
MG10DG-0.8 Wire Guide	23176	0.03150	0.80	6.013.0130.408
MG10DG-1.0 Wire Guide	23177	0.03937	1.00	6.013.0130.410
MG10DG-1.2 Wire Guide	23178	0.04724	1.20	6.013.0130.412
MG10DG-1.4 Wire Guide	23179	0.05512	1.40	6.013.0130.414
MG10DG-1.5 Wire Guide	23180	0.05906	1.50	6.013.0130.415
MG10DG-1.6 Wire Guide	21911	0.06299	1.60	6.013.0130.416
MG10DG-1.7 Wire Guide	23181	0.06693	1.70	6.013.0130.417
MG10DG-1.8 Wire Guide	16074	0.07087	1.80	6.013.0130.418
MG10DG-1.9 Wire Guide	15798	0.07480	1.90	6.013.0130.419
MG10DG-2.0 Wire Guide	16075	0.07874	2.00	6.013.0130.420
MG10DG-2.1 Wire Guide	23182	0.08268	2.10	6.013.0130.421
MG10DG-2.2 Wire Guide	16076	0.08661	2.20	6.013.0130.422
MG10DG-2.4 Wire Guide	13958	0.09449	2.40	6.013.0130.424
MG10DG-2.6 Wire Guide	23183	0.10236	2.60	6.013.0130.426
MG10DG-2.8 Wire Guide	19652	0.11024	2.80	6.013.0130.428
MG10DG-2.9 Wire Guide	21885	0.11417	2.90	6.013.0130.429
MG10DG-3.0 Wire Guide	21886	0.11811	3.00	6.013.0130.430
MG10DG-3.1 Wire Guide	21887	0.12205	3.10	6.013.0130.431
MG10DG-3.2 Wire Guide	19792	0.12598	3.20	6.013.0130.432
MG10DG-3.3 Wire Guide	23184	0.12992	3.30	6.013.0130.433
MG10DG-3.4 Wire Guide	21888	0.13386	3.40	6.013.0130.434
MG10DG-3.6 Wire Guide	22489	0.14173	3.60	6.013.0130.435
MG10DG-3.8 Wire Guide	19791	0.14961	3.80	6.013.0130.438
MG10DG-4.0 Wire Guide	23185	0.15748	4.00	6.013.0130.440
MG10DG-4.2 Wire Guide	23186	0.16535	4.20	6.013.0130.442
MG10DG-4.4 Wire Guide	23187	0.17323	4.40	6.013.0130.444
MG10DG-4.6 Wire Guide	21912	0.18110	4.60	6.013.0130.446
MG10DG-4.8 Wire Guide	23188	0.18898	4.80	6.013.0130.448
MG10DG-5.0 Wire Guide	23189	0.19685	5.00	6.013.0130.450
MG10DG-5.2 Wire Guide	23190	0.20472	5.20	6.013.0130.452
MG10DG-5.4 Wire Guide	23191	0.21260	5.40	6.013.0130.454
MG10DG-5.6 Wire Guide	23192	0.22047	5.60	6.013.0130.456
MG10DG-5.8 Wire Guide	23193	0.22830	5.80	6.013.0130.458
MG10DG-6.0 Wire Guide	23194	0.23620	6.00	6.013.0130.460
MG10DG-6.2 Wire Guide	23195	0.24410	6.20	6.013.0130.462
MG10DG-6.4 Wire Guide	23196	0.25200	6.40	6.013.0130.464
MG10DG-6.6 Wire Guide	23197	0.25980	6.60	6.013.0130.466
MG10DG-6.8 Wire Guide	23198	0.26770	6.80	6.013.0130.468
MG10DG-7.0 Wire Guide	23199	0.27560	7.00	6.013.0130.470
MG10DG-7.2 Wire Guide	19470	0.28350	7.20	6.013.0130.472
MG10DG-7.4 Wire Guide	23200	0.29133	7.40	6.013.0130.474
MG10DG-8.0 Wire Guide	23201	0.31500	8.00	6.013.0130.480
MG10DG-8.6 Wire Guide	23202	0.33860	8.60	6.013.0130.486