

MPF-32 Wire Prefeeding System

The **Mechtrix MPF-32 Wire Prefeeding System** is designed to remove electrical wire from reels, barrels, or auxiliary wire rack systems into its vertical multi-pulley draw source. This allows the wire to be immediately available for use by an automatic wire processing machine. The pulley configuration of the draw source additionally reduces the amount of force needed by the wire processing machine to feed the wire, by acting as a buffer between the wire source and the processing machine.

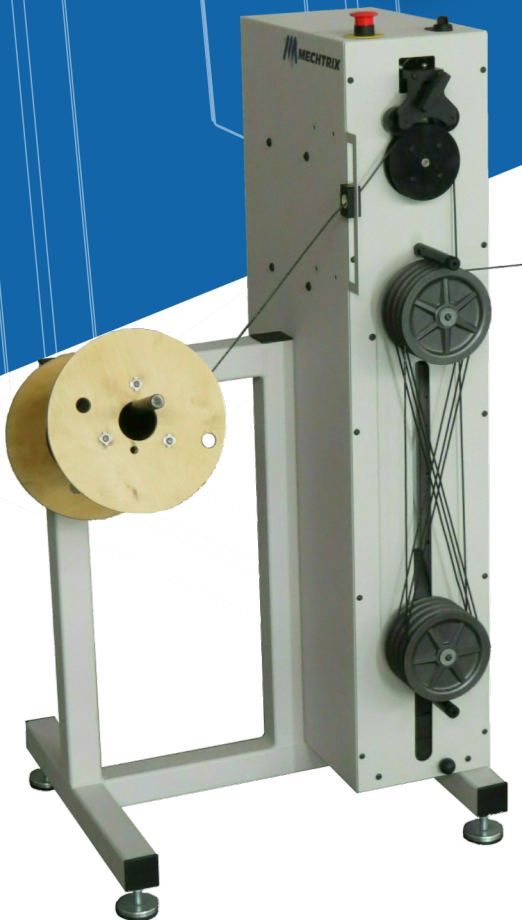

MPF-32 Wire Prefeeder System

STANDARD FEATURES

- **Mechtrix Auto-Tune®** proprietary prefeeder motor feed speed control system automatically adjusts the prefeeder's operating speed by monitoring the position of the accumulation pulleys.
- **High/Low Speed Selector Switch** for adjusting the prefeeder's sensitivity for shorter wire lengths or slower feeding job requirements
- **Adjustable Back-Tension Draw Source** makes up to 5m of wire immediately available
- **Multi-Position Wire Reel Holding Shaft Set-Up** allows for multiple wire feed paths and reel sizes.
- **Electronic Interface Connector, Cable, and Relay Assembly** send signals from the prefeeder to the wire processing machine if wire is not available due to a tangle or jam.
- **Compatible with Most Wire Processing Machines**

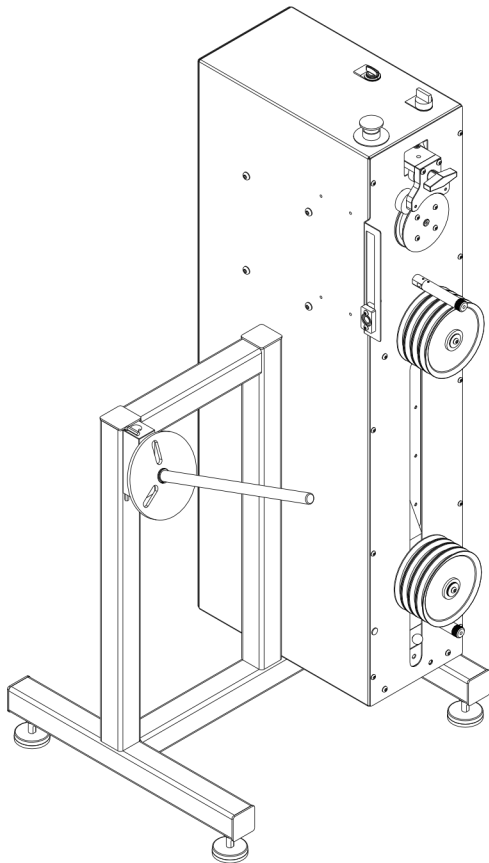

TECHNICAL DATA

Max Wire Reel Size & Weight:

Size: 16" (406mm) wide x Ø16" (Ø406mm)

Weight: 75lbs (28kg)

Max Pulling Force:

Max Wire O.D: 3/8" (9.5mm)

*Wire must be flexible enough to bend around a Ø5" (Ø127mm) pulley

Wire Draw Source Capacity:

Top Feed Speed:

High: 10.5ft/sec (3.2m/sec)

Low: 5.25ft/sec (1.6m/sec)

Machine Weight:

Motor Control System:

Electrical Requirement Options:

- 115VAC, 10AMP, 60HZ

- 230VAC, 10AMP, 50HZ

Wire Line Output Height:

