

Misc. Blades and Tooling

Table of Contents

In addition to custom application blades, Mechtrix can manufacture blades for virtually any wire processing machine. Unfortunately, due to the vast number of wire processing machine makers and models and the overwhelming combinations and permutations of blades possible, we are simply not able to list everything we manufacture in our catalog. If you need a blade for a machine or manufacturer that's not shown, please contact Mechtrix and we will quote you on the highest quality, longest lasting, low cost replacement blade possible.

Carpenter Mfg. Co. Inc. Model 71 and 71SB, Model 72B, Model 73, Model 77E, Model 90, Model 94, Model 93 and 97A	Misc. Tooling - 2
Eraser Company Inc. Eraser CM20, Eraser WC300 and WC301	Misc. Tooling - 5
Feintechnik Rittmeyer (be-ri) AM.STRIP.1, AM.STRIP.2, AM.STRIP.015 and AM.ALL.ROUND Machines	Misc. Tooling - 6
Ideal Industries Inc. (Artos Engineering) 45-048, 45-064, 45-065, 45-211, 45-212, 45-700, 45-701, 45-705, 45-725, 45-730, 45-940, 45-945, 45-750	Misc. Tooling - 7
Kirsten AG (Schleuniger Systems AG) PP3, K700, K710, K750 ASC, K750	Misc. Tooling - 12
KM Digitech Corporation KM-702N, KM703N	Misc. Tooling - 14
KMI Wire Processing Technology KM-104N, Contact ST, Contact ST5, Contact DWF 5, Contact TR, Extreme, Junior	Misc. Tooling - 15
Kormak	Misc. Tooling - 17
Kut-Rite/Weix	Misc. Tooling - 17
Makfil Systems Srl	Misc. Tooling - 17
MCM Cosmic MCM Cosmic 30M, MCM Cosmic 32M, MCM Cosmic 60R, MCM Cosmic 927R	Misc. Tooling - 18
Mecal Srl SC10, SC11, SC12, SC19	Misc. Tooling - 21
Metzner Maschinenbau GmbH	Misc. Tooling - 22
PAWO Sytems AG (Schleuniger Systems AG) B12, B16, B21, Servo Stripper	Misc. Tooling - 23
ShinMaywa Industries Ltd. TR10, TR20, TR30, THR20, THR30, TR111, TR201, TR202, TRD111, TRD301 TRD302	Misc. Tooling - 24
Tekuwa GmbH (Dorema)	Misc. Tooling - 30
Yazaki	Misc. Tooling - 31

Mechtrix Blades Are Also Available for The Following OEM's Machines

ARA (Komax Systems), Arno Fuchs Kabeltechnik, Coastel Cable Tools, DooSung Machinery Ind. Co. Ltd. (Sona), Foung-E Co. Ltd., ITT Cannon, Major Electronics, Nippon Tanshi, Ramatech Systems AG, Remarcable, Streckfuss USA, Z+F Zoller+Fröhlich GmbH and many others

Rev. 08/01/10



Mechtrix Corporation • W147 N9461 Held Drive • Menomonee Falls, WI 53051
Tel (262) 255-6555 • Fax (262) 255-2628 • Website <http://www.mechtrix.com>

Misc. Blades and Tooling

Carpenter Model 71 and 71SB Wire Strippers

Used In These
Machines

Carpenter
Model 71
Model 71SB



The Carpenter Model 70 and 71SB Machines use a single set of "Universal" Stripping Blades to remove the insulation from the end of a wire. Mechtrix blades for the Carpenter Model 70 and 71SB Machines are made to precision standards from a specially selected tool steel to insure optimum performance and blade life and are produced using state-of-the-art manufacturing techniques. The state-of-the-art manufacturing techniques are combined with patented Mechtrix technology to produce perfect stripping form radii.

In addition to the "Universal" Stripping Blades, Mechtrix also offers both our patented M-Series and Full Radius stripping form geometries for processing difficult insulations in the Carpenter Model 70 and 71SB Machines. Please contact Mechtrix for assistance in selecting the appropriate style and size blade for your particular application.

Carpenter Model 71 and 71SB Stripping Blades

Mechtrix Description	Mechtrix Part Number	Blade Form Diameter		OEM Part Number
		(in)	(mm)	
Carpenter Model 71 Universal V Stripping Blades	12157	-	-	7105
Carpenter Model 71SB Straight Strip Blade-Left	13965	-	-	7168
Carpenter Model 71SB Straight Strip Blade-Right	13966	-	-	

Carpenter Model 72B Wire Strippers

Used In These
Machines

Carpenter
Model 72B



The Carpenter Model 72B Machine uses a single set of "Universal" Stripping Blades to remove the insulation from the end of a wire. Mechtrix blades for the Carpenter Model 72B Machines are made to precision standards from a specially selected tool steel to insure optimum performance and blade life and are produced using state-of-the-art manufacturing techniques. The state-of-the-art manufacturing techniques are combined with patented Mechtrix technology to produce perfect stripping form radii.

Carpenter Model 72B Stripping Blades

Mechtrix Description	Mechtrix Part Number	Blade Form Diameter		OEM Part Number
		(in)	(mm)	
Carpenter Model 72B Universal Stripping Blades	28716	-	-	-

Carpenter Model 73 Wire Strippers

Used In These
Machines

Carpenter
Model 73

The Carpenter Model 73 Machines use a single set of Radius-V Stripping Blades to remove the insulation from the end of a wire. Mechtrix blades for the Carpenter Model 70 and 71SB Machines are made to precision standards from a specially selected tool steel to insure optimum performance and blade life and are produced using state-of-the-art manufacturing techniques. The state-of-the-art manufacturing techniques are combined with patented Mechtrix technology to produce perfect stripping form radii. Please contact Mechtrix for assistance in selecting the appropriate style and size blade for your particular application.

Misc. Blades and Tooling

Carpenter Model 77E Wire Strippers

Used In These Machines

Carpenter Model 77E

The Carpenter Model 77E Machines use a single set of "Universal" Stripping Blades to remove the insulation from the end of a wire. Mechtrix blades for the Carpenter Model 77E Machines are made to precision standards from a specially selected tool steel to insure optimum performance and blade life and are produced using state-of-the-art manufacturing techniques. The state-of-the-art manufacturing techniques are combined with patented Mechtrix technology to produce perfect stripping form radii.



In addition to the "Universal" Stripping Blades, Mechtrix also offers die-type stripping form geometries for processing difficult insulations in the Carpenter Model 77E Machines. Please contact Mechtrix for assistance in selecting the appropriate style and size blade for your particular application.

Carpenter Model 77E Stripping Blades

Mechtrix Description	Mechtrix Part Number	Blade Form Diameter		OEM Part Number
		(in)	(mm)	
Carpenter Model 77E Universal Stripping Blades	27625	-	-	7715
Carpenter Model 77E Die Blades	Contact Mechtrix for Specific Sizing			7590

Carpenter Model 90 Wire Strippers

Used In These Machines

Carpenter Model 90

The Carpenter Model 90 Machines use a single set of "Universal" Stripping Blades to remove the insulation from the end of a wire. Mechtrix blades for the Carpenter Model 90 Machines are made to precision standards from a specially selected tool steel to insure optimum performance and blade life and are produced using state-of-the-art manufacturing techniques. The state-of-the-art manufacturing techniques are combined with patented Mechtrix technology to produce perfect stripping form radii.



In addition to the "Universal" Stripping Blades, Mechtrix also offers both our patented M-Series and Full Radius stripping form geometries for processing difficult insulations in the Carpenter Model 90 Machines. Please contact Mechtrix for assistance in selecting the appropriate style and size blade for your particular application.

Carpenter Model 90 Stripping Blades

Mechtrix Description	Mechtrix Part Number	Blade Form Diameter		OEM Part Number
		(in)	(mm)	
Carpenter Model 90 Universal Stripping Blades	31760	-	-	-

Carpenter Model 94 Wire Strippers

Used In These Machines

Carpenter Model 94

The Carpenter Model 94 Machines use a single set of "Universal" Stripping Blades to remove the insulation from the end of a wire. Mechtrix blades for the Carpenter Model 94 Machines are made to precision standards from a specially selected tool steel to insure optimum performance and blade life and are produced using state-of-the-art manufacturing techniques. The state-of-the-art manufacturing techniques are combined with patented Mechtrix technology to produce perfect stripping form radii.



In addition to the "Universal" Stripping Blades, Mechtrix also offers both our patented M-Series and Full Radius stripping form geometries for processing difficult insulations in the Carpenter Model 94 Machines. Please contact Mechtrix for assistance in selecting the appropriate style and size blade for your particular application.

Carpenter Model 94 Stripping Blades

Mechtrix Description	Mechtrix Part Number	Blade Form Diameter		OEM Part Number
		(in)	(mm)	
Carpenter Model 94 Universal Stripping Blades	30551	-	-	-



Mechtrix Corporation • W147 N9461 Held Drive • Menomonee Falls, WI 53051
Tel (262) 255-6555 • Fax (262) 255-2628 • Website <http://www.mechtrix.com>

Misc. Blades and Tooling

Carpenter Model 93 and 97A Wire Strippers

Used In These
Machines

Carpenter
Model 93
Model 97A

The Carpenter Model 93 and 97A Machines use a single set of "Universal" Stripping Blades to remove the insulation from the end of a wire. Mechtrix blades for the Carpenter Model 93 and 97A Machines are made to precision standards from a specially selected tool steel to insure optimum performance and blade life and are produced using state-of-the-art manufacturing techniques. The state-of-the-art manufacturing techniques are combined with patented Mechtrix technology to produce perfect stripping form radii.

In addition to the "Universal" Stripping Blades, Mechtrix also offers both our patented M-Series and Full Radius stripping form geometries for processing difficult insulations in the Carpenter Model 93 and 97A Machines. Please contact Mechtrix for assistance in selecting the appropriate style and size blade for your particular application.



Carpenter 93 and 97A Universal Stripping and Cut-off Blades

Mechtrix Description	Mechtrix Part Number	Blade Form Diameter		OEM Part Number
		(in)	(mm)	
Carpenter C97 Universal Strip Blade (Tool Steel)	26496-03	-	-	08961
Carpenter C97 Universal Strip Blade (Carbide)	26496-02	-	-	-
Carpenter C97 Heavy Duty Strip Blade (Tool Steel)	26497-03	-	-	-
Carpenter C97 Heavy Duty Strip Blade (Carbide)	26497-02	-	-	-

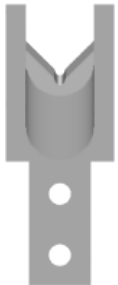

Carpenter 93 and 97A M-Series Blades

Mechtrix Description	Mechtrix Part Number	Blade Form Diameter		OEM Part Number
		(in)	(mm)	
M-Series Blades are available in 0.1mm increments in the following sizes: C97M-0.4 thru C97M-4.0	-	-	-	-

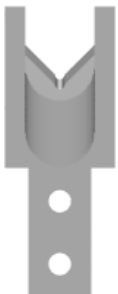

Carpenter 93 and 97A Full Radius Blades

Mechtrix Description	Mechtrix Part Number	Blade Form Diameter		OEM Part Number
		(in)	(mm)	
Full Radius Blades are available in 0.1mm increments in the following sizes: C97-0.4D thru C97-4.0D	-	-	-	-

Misc. Blades and Tooling

Eraser CM20 Stripping Blades

Used In These
Machines

The Eraser CM20 Machines use a rotating blade to strip the insulation from a cable. Mechtrix blades for the Eraser CM20 Machines are made to precision standards from a specially selected tool steel or specially selected tungsten carbide to insure optimum performance and blade life.

Eraser
CM20



Eraser CM20 Stripping Blades

Mechtrix Description	Mechtrix Part Number	Blade Form Diameter		OEM Part Number
		(in)	(mm)	
Eraser CM20 Stripping Blade	32159	-	-	IR0154

Eraser WC300 and WC301 Wire and Cable Cutter

Used In These
Machines

The Eraser WC300 and WC301 Machines use set of blades to cut material to length. Mechtrix blades for the Eraser WC300 and WC301 Machines are made to precision standards from a specially selected tool steel or specially selected tungsten carbide to insure optimum performance and blade life.

Eraser
WC300
WC301



Eraser WC300 and WC301 Cutting Blades

Mechtrix Description	Mechtrix Part Number	Blade Form Diameter		OEM Part Number
		(in)	(mm)	
Eraser WC300 and WC301 Cutting Blade (Carbide)	31835-01	-	-	IR1196
Eraser WC300 and WC301 Cutting Blade (Tool Steel)	31835-02	-	-	IR0931
Eraser WC300 and WC301 Cutting Plate (Tool Steel)	-	-	-	IR0928

Misc. Blades and Tooling

Feintechnik Rittmeyer (be-ri) Machines

Used In These Machines

Rittmeyer
AM.STRIP.1
AM.STRIP.2
AM.STRIP.015
AM.ALL.ROUND

Mechtrix offers a complete line of blades for Feintechnik Rittmeyer (be-ri) AM wire processing machines.

AM.STRIP.1 and AM.STRIP.2 Strip Blades

Mechtrix stripping blades for the AM.STRIP.1 and AM.STRIP.2 machines are made to precision standards from a specially selected tool steel to insure optimum performance and blade life and are produced using state-of-the-art manufacturing techniques.

Please contact Mechtrix for assistance in selecting the appropriate style and size blade for your specific AM.STRIP.1 or AM,STRIP.2 wire processing application.

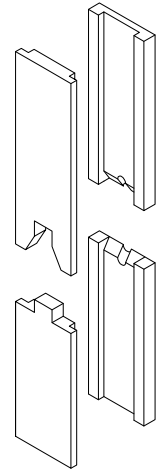

AM.STRIP.0.15 Strip Blades

Mechtrix stripping blades for the AM.STRIP.015 machines are made to precision standards from a specially selected tool steel to insure optimum performance and blade life and are produced using state-of-the-art manufacturing techniques.

In addition to the "Universal" and "Straight" stripping blades for the AM.STRIP.015 machines Mechtrix also offers both our patented M-Series and Full Radius stripping form geometries for processing difficult insulations in the AM.STRIP.015 machines. Please contact Mechtrix for assistance in selecting the appropriate style and size blade for your particular application.



AM.STRIP.015 Universal Blades

Mechtrix Description	Mechtrix Part Number	Blade Form Diameter		OEM Part Number
		(in)	(mm)	
AM.STRIP.015 Universal Stripping Blade	17519	-	-	028.0060
AM.STRIP.015 Straight Stripping Blade	28220	-	-	028.0063



AM.ALL.ROUND Strip Blades

Mechtrix stripping blades for the AM.ALL.ROUND machines are made to precision standards from a specially selected tool steel to insure optimum performance and blade life and are produced using state-of-the-art manufacturing techniques.

AM.ALL.ROUND Universal Blades

Mechtrix Description	Mechtrix Part Number	Blade Form Diameter		OEM Part Number
		(in)	(mm)	
AM.ALL.ROUND Universal Blades	22494	-	-	039.0080

Misc. Blades and Tooling

Ideal/Artos 45-048 Wire and Cable Cutter

Used In These Machines

Ideal/Artos
45-048

The Ideal/Artos 45-048 Wire and Cable Cutters use a single set of blades to cut material to length. Mechtrix blades for the Ideal/Artos 45-048 Wire and Cable Cutters are made to precision standards from a specially selected tool steel or specially selected tungsten carbide to insure optimum performance and blade life.

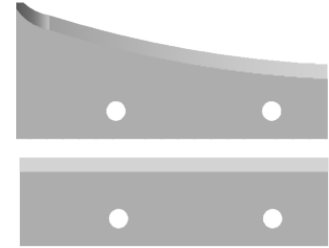

Ideal/Artos 45-048 Wire and Cable Cutter

Mechtrix Description	Mechtrix Part Number	Blade Form Diameter		OEM Part Number
		(in)	(mm)	
Ideal/Artos 45-048 Cut-off Blade-Upper	19226	-	-	L-6038
Ideal/Artos 45-048 Cut-off Blade-Lower	19225	-	-	L-6039
Ideal/Artos 45-048 Wire and Cable Cutter Blade Set	Order (1) 19255 & (1) 19226 for a set			L-6040

Ideal/Artos 45-064 Standard-Lever Stripping Machines

Used In These Machines

Ideal/Artos
45-064
45-665

Mechtrix offers a complete line of lever stripping blades for the Ideal/Artos 45-064 Lever Stripping Machines. The blades are made of specially alloyed tool-steel and feature a sharp cutting edge around the entire stripping blade form. The blades are designated by the prefix "SID" and the standard blade sizes are shown below. Mechtrix also offers additional "SID" sizes in 0.1mm radii increments. For specific sizing information or for a blade not listed please contact Mechtrix.

Ideal/Artos Standard-Lever Stripper Blades for 45-064

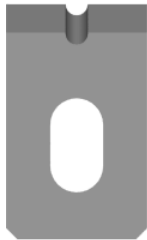

Mechtrix Description	Mechtrix Part Number	Blade Form Diameter		OEM Part Number
		(in)	(mm)	
SID Straight Strip Blade	8715	-	-	L-3064
SID-1.0 Stripping Blade	32086	.0390	1.0	L-3616
SID-1.5 Stripping Blade	32087	.0595	1.5	L-3065
SID-2.0 Stripping Blade	32088	.0785	2.0	L-3066
SID-2.5 Stripping Blade	27502	.0995	2.5	L-3067
SID-3.0 Stripping Blade	14427	.1200	3.0	L-3068
SID-3.6 Stripping Blade	16049	.1405	3.6	L-3069
SID-4.1 Stripping Blade	28350	.1610	4.1	L-3070
SID-4.6 Stripping Blade	28171	.1820	4.6	L-3071
SID-5.2 Stripping Blade	25908	.2040	5.2	L-3072
SID-5.8 Stripping Blade	30350	.2280	5.8	L-3073
SID-6.4 Stripping Blade	14090	.2500	6.4	L-3074
SID-6.9 Stripping Blade	26301	.2720	6.9	L-3617
SID-7.4 Stripping Blade	14429	.2900	7.4	L-3075
SID-7.9 Stripping Blade	28614	.3125	7.9	L-3076
SID-8.4 Stripping Blade	16065	.3320	8.4	L-3618
SID-8.8 Stripping Blade	27573	.3480	8.8	L-3077
SID-9.3 Stripping Blade	16064	.3680	9.3	L-3619
SID-9.8 Stripping Blade	30518	.3860	9.8	L-3078
SID-10.3 Stripping Blade	30458	.4040	10.3	L-3620
SID-10.7 Stripping Blade	26336	.4210	10.7	L-3621
SID-11.1 Stripping Blade	20812	.4375	11.1	L-3079
SID-11.5 Stripping Blade	28857	.4530	11.5	L-3622
SID-11.9 Stripping Blade	27574	.4680	11.9	L-3628

Misc. Blades and Tooling

Ideal/Artos 45-065 Large-Lever Stripping Machines

Used In These
Machines

Ideal/Artos
45-065
45-665

Mechtrix offers a complete line of lever stripping blades for the Ideal/Artos 45-065 Lever Stripping Machines. The blades are made of specially alloyed tool-steel and feature a sharp cutting edge around the entire stripping blade form. The blades are designated by the prefix "IDEAL-LL" and the standard blade sizes are shown below. Mechtrix also offers additional "IDEAL-LL" sizes in 0.1mm radii increments. For specific sizing information or for a blade not listed please contact Mechtrix.

Ideal/Artos Large-Lever Stripper Blades for 45-065

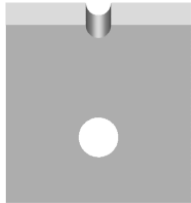

Mechtrix Description	Mechtrix Part Number	Blade Form Diameter		OEM Part Number
		(in)	(mm)	
IDEAL-LL Straight Stripping Blade	18337	-	-	I-6561
IDEAL-LL-7.9 Stripping Blade	30297	.312	7.9	I-6559
IDEAL-LL-8.8 Stripping Blade	30298	.348	8.8	I-6558
IDEAL-LL-9.8 Stripping Blade	24648	.386	9.8	I-6557
IDEAL-LL-10.2 Stripping Blade	30299	.400	10.2	I-6556
IDEAL-LL-10.7 Stripping Blade	30207	.421	10.7	I-6555
IDEAL-LL-11.1 Stripping Blade	32089	.435	11.1	I-6537
IDEAL-LL-11.9 Stripping Blade	30300	.468	11.9	I-6538
IDEAL-LL-12.7 Stripping Blade	24649	.500	12.7	I-6539
IDEAL-LL-13.3 Stripping Blade	32090	.525	13.3	I-6540
IDEAL-LL-14.2 Stripping Blade	32091	.560	14.2	I-6541
IDEAL-LL-15.2 Stripping Blade	30206	.600	15.2	I-6542
IDEAL-LL-15.9 Stripping Blade	24558	.625	15.9	I-6543
IDEAL-LL-16.5 Stripping Blade	32092	.650	16.5	I-6544
IDEAL-LL-17.8 Stripping Blade	32093	.700	17.8	I-6545
IDEAL-LL-19.1 Stripping Blade	32094	.750	19.1	I-6546
IDEAL-LL-20.3 Stripping Blade	32095	.800	20.3	I-6547
IDEAL-LL-21.6 Stripping Blade	30086	.850	21.6	I-6548
IDEAL-LL-22.4 Stripping Blade	32096	.880	22.4	I-6549
IDEAL-LL-24.0 Stripping Blade	32097	.925	24.0	I-6550
IDEAL-LL-24.4 Stripping Blade	32098	.960	24.4	I-6551
IDEAL-LL-25.4 Stripping Blade	32099	1.000	25.4	I-6552
IDEAL-LL-27.2 Stripping Blade	32100	1.070	27.2	I-6553
IDEAL-LL-28.6 Stripping Blade	32101	1.125	28.6	I-6554

Misc. Blades and Tooling

Ideal/Artos 45-211 and 45-212 Precision Rotary Strippers

Used In These
Machines

Ideal/Artos
45-211
45-212

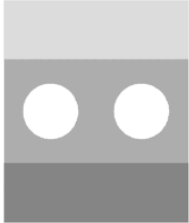

The Mechtrix blades for the Ideal/Artos 45-211 and 45-212 Precision Rotary Strippers are made from a specially selected tungsten carbide to provide for extended life and a precision strip.

Ideal/Artos 45-211 and 45-212 Precision Rotary Stripper Blade

Mechtrix Description	Mechtrix Part Number	Blade Form Diameter		OEM Part Number
		(in)	(mm)	
Ideal/Artos 45-211 Rotary Strip Blade (Carbide)	19020	-	-	L-7706

Ideal/Artos 45-700, 45-701 and 45-705 Wire Prepper System II

Used In These
Machines

Ideal/Artos
45-700
45-701
45-705

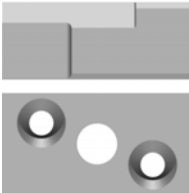

The Ideal/Artos 45-700, 45-701 and 45-705 Wire Prepper System II Machines use a single set of blades to cut material to length. Mechtrix blades for the Ideal/Artos 45-700, 45-701 and 45-705 Wire Prepper System II Machines are made to precision standards from a specially selected tool steel or specially selected tungsten carbide to insure optimum performance and blade life.

Ideal/Artos 45-700, 45-701 and 45-705 Wire Prepper II Blades

Mechtrix Description	Mechtrix Part Number	Blade Form Diameter		OEM Part Number
		(in)	(mm)	
Ideal/Artos 45-700 Moving Blade (Carbide)	31747	-	-	LB-667
Ideal/Artos 45-700 Stationary Blade (Carbide)	31748	-	-	K-6336

Ideal/Artos 45-725 and 45-730 Wire Prepper Lite

Used In These
Machines

Ideal/Artos
45-725
45-730

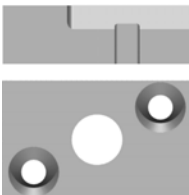

The Ideal/Artos 45-725 and 45-730 Wire Prepper Lite Machines use a single set of blades to cut material to length. Mechtrix blades for the Ideal/Artos 45-725 and 45-730 Wire Prepper Lite Machines are made to precision standards from a specially selected tool steel or specially selected tungsten carbide to insure optimum performance and blade life.

Ideal/Artos 45-725 and 45-730 Wire Prepper Lite Blades

Mechtrix Description	Mechtrix Part Number	Blade Form Diameter		OEM Part Number
		(in)	(mm)	
Ideal/Artos 45-725 Moving Blade	17095	-	-	LB-1609
Ideal/Artos 45-725 Stationary Blade	17094	-	-	K-7265



Mechtrix Corporation • W147 N9461 Held Drive • Menomonee Falls, WI 53051
Tel (262) 255-6555 • Fax (262) 255-2628 • Website <http://www.mechtrix.com>

Misc. Blades and Tooling

Ideal 45-750 Series Stripping Blades

Used In These Machines

Ideal
45-750

The Ideal 45-750 Machine uses a single set of "Universal" Stripping Blades to remove the insulation from the end of a wire. Mechtrix blades for the 45-750 Machines are made to precision standards from a specially selected tool steel to insure optimum performance and blade life and are produced using state-of-the-art manufacturing techniques. The state-of-the-art manufacturing techniques are combined with patented Mechtrix technology to produce perfect stripping form radii.

Artos
CS-336
CS-337
CS-338

In addition to the "Universal" Stripping Blades, Mechtrix also offers both our patented M-Series and Full Radius stripping form geometries for processing difficult insulations in the 45-750 Machine. Please contact Mechtrix for assistance in selecting the appropriate style and size blade for your particular application.

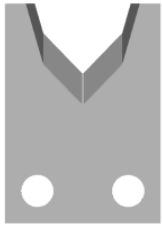

Ideal 45-750 Universal Stripping and Cut-off Blades

Mechtrix Description	Mechtrix Part Number	Blade Form Diameter		OEM Part Number
		(in)	(mm)	
A336VU Stripping Blade	12876	-	-	LB-1253
A336VU w/(TiN) Coating Stripping Blade	12876-CT1	-	-	LB-1725



Ideal 45-750 M-Series Blades

Mechtrix Description	Mechtrix Part Number	Blade Form Diameter		OEM Part Number
		(in)	(mm)	
M-Series Blades are available in 0.1mm increments in the following sizes: CS336M-0.4 thru CS336M-4.0	-	-	-	-



Ideal 45-750 Full Radius Blades

Mechtrix Description	Mechtrix Part Number	Blade Form Diameter		OEM Part Number
		(in)	(mm)	
Full Radius Blades are available in 0.1mm increments in the following sizes: CS336-0.4D thru CS336-4.0D	-	-	-	-

Mechtrix "45-750" Stripping Blades are covered by U.S. Pat. 4,630,406 and U.S. Pat. 4,577,405

Misc. Blades and Tooling

Ideal/Artos 45-940 and 45-945 Pneumatic Wire Strippers

Used In These
Machines

Ideal/Artos
45-940
45-945

The Ideal/Artos 45-940 and 45-945 Machines use a single set of "Universal" Stripping Blades to remove the insulation from the end of a wire. Mechtrix blades for the Ideal/Artos 45-940 and 45-945 Machines are made to precision standards from a specially selected tool steel to insure optimum performance and blade life and are produced using state-of-the-art manufacturing techniques. The state-of-the-art manufacturing techniques are combined with patented Mechtrix technology to produce perfect stripping form radii.

In addition to the "Universal" Stripping Blades, Mechtrix also offers both our patented M-Series and Full Radius stripping form geometries for processing difficult insulations in the Ideal/Artos 45-940 and 45-945 Machines. Please contact Mechtrix for assistance in selecting the appropriate style and size blade for your particular application.



Ideal/Artos 45-940 Universal Stripping Blades

Mechtrix Description	Mechtrix Part Number	Blade Form Diameter		OEM Part Number
		(in)	(mm)	
Ideal/Artos 45-940UV Universal Strip Blade	30378	-	-	LA-3846
Ideal/Artos 45-940V-1.9 Strip Blade	-	0.075	1.90	LA-3847
Ideal/Artos 45-940V-2.4 Strip Blade	-	0.095	2.40	LA-3848
Ideal/Artos 45-940V-2.9 Strip Blade	-	0.115	2.90	LA-3849
Ideal/Artos 45-940V-3.4 Strip Blade	-	0.135	3.40	LA-3850

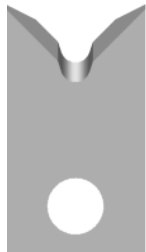

Ideal/Artos 45-940 and 45-945 M-Series Blades

Mechtrix Description	Mechtrix Part Number	Blade Form Diameter		OEM Part Number
		(in)	(mm)	
M-Series Blades are available in 0.1mm increments in the following sizes: Ideal/Artos 45-940M-0.4 thru Ideal/Artos 45-940M-4.0	-	-	-	-

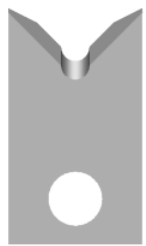

Ideal/Artos 45-940 and 45-945 Full Radius Blades

Mechtrix Description	Mechtrix Part Number	Blade Form Diameter		OEM Part Number
		(in)	(mm)	
Full Radius Blades are available in 0.1mm increments in the following sizes: Ideal/Artos 45-940-0.4D thru Ideal/Artos 45-940-4.0D	-	-	-	-

Misc. Blades and Tooling

Kirsten/Schleuniger PP3 Stripper/Crimper Machines

Used In These Machines

- Kirsten
- PP3
- PP3 WS
- PP3 Special
- PP3 Special LTC

The Kirsten/Schleuniger PP3 Machines use a single set of "Universal" Stripping Blades to remove the insulation from the end of a wire. Mechtrix blades for the PP3 Machines are made to precision standards from a specially selected tool steel to insure optimum performance and blade life and are produced using state-of-the-art manufacturing techniques.

In addition to the "Universal" Stripping Blades, Mechtrix also offers both our patented M-Series and Full Radius stripping form geometries for processing difficult insulations in the PP3 Machines. Please contact Mechtrix for assistance in selecting the appropriate style and size blade for your particular application.

Kirsten PP3 Stripper/Crimper Blades (Old Style)



Mechtrix Description	Mechtrix Part Number	Blade Form Diameter		OEM Part Number
		(in)	(mm)	
Kirsten PP3 Universal-Short	7094	-	-	-
Kirsten PP3 Universal-Long	7095	-	-	-

Kirsten PP3 Stripper/Crimper Blades (New Interlocking Style)



Mechtrix Description	Mechtrix Part Number	Blade Form Diameter		OEM Part Number
		(in)	(mm)	
Kirsten PP3 Universal-Short	17007	-	-	3.0048
Kirsten PP3 Universal-Long	17005	-	-	3.0049

Kirsten/Schleuniger K700 and K710 Stripper/Crimper Machines

Used In These Machines

- Kirsten
- K700 ASC
- K710 ASC

The Kirsten/Schleuniger K700 ASC and K710 ASC Machines use a single set of "Universal" Stripping Blades to remove the insulation from the end of a wire. Mechtrix blades for the Kirsten K700 and 710 Series Machines are made to precision standards from a specially selected tool steel to insure optimum performance and blade life and are produced using state-of-the-art manufacturing techniques.

In addition to the "Universal" Stripping Blades, Mechtrix also offers both our patented M-Series and Full Radius stripping form geometries for processing difficult insulations in the K700 and K710 Series Machines. Please contact Mechtrix for assistance in selecting the appropriate style and size blade for your particular application.

Kirsten K700 and K710 Stripper/Crimper Blades



Mechtrix Description	Mechtrix Part Number	Blade Form Diameter		OEM Part Number
		(in)	(mm)	
Kirsten K700ASC Universal-Short	19104	-	-	431.001.155
Kirsten K700ASC Universal-Long	19105	-	-	431.001.156

Misc. Blades and Tooling

Kirsten K750 ASC and Schleuniger StripCrimp 200 Machines

Used In These Machines

Kirsten
K750 ASC
StripCrimp 200

The Kirsten K750 ASC and Schleuniger StripCrimp 200 Machines use a single set of "Universal" Stripping Blades to remove the insulation from the end of a wire. Mechtrix blades for the Kirsten K750 ASC and Schleuniger StripCrimp 200 Series Machines are made to precision standards from a specially selected tool steel to insure optimum performance and blade life and are produced using state-of-the-art manufacturing techniques.

In addition to the "Universal" Stripping Blades, Mechtrix also offers both our patented M-Series and Full Radius stripping form geometries for processing difficult insulations in the K750 ASC and Schleuniger StripCrimp 200 Series Machines. Please contact Mechtrix for assistance in selecting the appropriate style and size blade for your particular application.

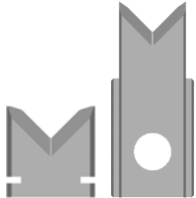

Kirsten K750 and Schleuniger StripCrimp 200 Stripper/Crimper Blades

Mechtrix Description	Mechtrix Part Number	Blade Form Diameter		OEM Part Number
		(in)	(mm)	
Kirsten K750 Universal-Short	19104	-	-	405.103.147
Kirsten K750 Universal-Long	27270	-	-	405.103.149

Kirsten/Schleuniger StripCrimp 750 Stripper/Crimper Machines

Used In These Machines

Schleuniger
StripCrimp 750

The Kirsten/Schleuniger StripCrimp 750 Machines use a single set of "Universal" Stripping Blades to remove the insulation from the end of a wire. Mechtrix blades for the StripCrimp 750 Series Machines are made to precision standards from a specially selected tool steel to insure optimum performance and blade life and are produced using state-of-the-art manufacturing techniques.

In addition to the "Universal" Stripping Blades, Mechtrix also offers both our patented M-Series and Full Radius stripping form geometries for processing difficult insulations in the StripCrimp 750 Machines. Please contact Mechtrix for assistance in selecting the appropriate style and size blade for your particular application.



Schleuniger StripCrimp 750 Stripper/Crimper Blades (s/n 100346 and below)

Mechtrix Description	Mechtrix Part Number	Blade Form Diameter		OEM Part Number
		(in)	(mm)	
Kirsten K700ASC Universal-Short	19104	-	-	431.001.155
Kirsten K700ASC Universal-Long	19105	-	-	431.001.156

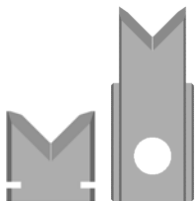

Schleuniger StripCrimp 750 Stripper/Crimper Blades (s/n 100347 and above)

Mechtrix Description	Mechtrix Part Number	Blade Form Diameter		OEM Part Number
		(in)	(mm)	
Kirsten K750 Universal-Short	19104	-	-	405.103.147
Kirsten K750 Universal-Long	27270	-	-	405.103.149



Mechtrix Corporation • W147 N9461 Held Drive • Menomonee Falls, WI 53051
Tel (262) 255-6555 • Fax (262) 255-2628 • Website <http://www.mechtrix.com>

Misc. Blades and Tooling

KM Digitech KM-702N Machines

Used In These Machines

KM Digitech
KM-702N



The KM Digitech KM-702N Machines use a single set of "Universal" Stripping Blades per wire position to remove the insulation from the end of a wire. Mechtrix blades for the KM-702N Machines are made to precision standards from a specially selected tungsten carbide to insure optimum performance and blade life and are produced using state-of-the-art manufacturing techniques.

In addition to the "Universal" Stripping Blades, Mechtrix also offers both our patented M-Series and Full Radius stripping form geometries for processing difficult insulations in the KM-702N Machines. Please contact Mechtrix for assistance in selecting the appropriate style and size blade for your particular application.

KM Digitech KM-702N Universal Blades

Mechtrix Description	Mechtrix Part Number	Blade Form Diameter		OEM Part Number
		(in)	(mm)	
KM-702N Universal Strip/Cut Blades (C17)	29561	-	-	-

KM Digitech KM-703N Machines

Used In These Machines

KM Digitech
KM-703N



The KM Digitech KM-703N Machines use a single set of "Universal" Stripping Blades per wire position to remove the insulation from the end of a wire. Mechtrix blades for the KM-703N Machines are made to precision standards from a specially selected tungsten carbide to insure optimum performance and blade life and are produced using state-of-the-art manufacturing techniques.

In addition to the "Universal" Stripping Blades, Mechtrix also offers both our patented M-Series and Full Radius stripping form geometries for processing difficult insulations in the KM-703N Machines. Please contact Mechtrix for assistance in selecting the appropriate style and size blade for your particular application.

KM Digitech KM-703N Universal Blades

Mechtrix Description	Mechtrix Part Number	Blade Form Diameter		OEM Part Number
		(in)	(mm)	
KM-703N Universal Strip/Cut Blade-Long (C17)	28874-03	-	-	-
KM-703N Universal Strip/Cut Blade-Short (C17)	28875-03	-	-	-

Misc. Blades and Tooling

KM Digitech KM-104N Stripping Blades

Used In These
Machines

KM Digitech
KM-104N



The KM Digitech KM-104N Machines use "Universal" Style Stripping Blades to remove the insulation from the end of a wire. Mechtrix blades for the KM Digitech Machines are made to precision standards from a specially selected tool steel to insure optimum performance and blade life and are produced using state-of-the-art manufacturing techniques. The state-of-the-art manufacturing techniques are combined with patented Mechtrix technology to produce perfect stripping form radii.

In addition to the "Universal" Stripping Blades, Mechtrix also offers both our patented M-Series and Full Radius stripping form geometries for processing difficult insulations in the KM Digitech KM-104N Machines. Please contact Mechtrix for assistance in selecting the appropriate style and size blade for your particular application.

KM Digitech KM-104N Universal Stripping and Cut-off Blades

Mechtrix Description	Mechtrix Part Number	Blade Form Diameter		OEM Part Number
		(in)	(mm)	
KM-104N Universal Strip Blade-Upper Left	29638-CT1	-	-	-
KM-104N Universal Strip Blade-Lower Left	29636-CT1	-	-	-
KM-104N Universal Strip Blade-Upper Right	29639-CT1	-	-	-
KM-104N Universal Strip Blade-Lower Right	29637-CT1	-	-	-
KM-104N Lower Cut-off Blade	29640-CT1	-	-	-
KM-104N Upper Cut-off Blade	29641-CT1	-	-	-
KM-104N (DT) Cut-off Blade	29642-CT1	-	-	-

KM Digitech KM-104N M-Series Blades

Mechtrix Description	Mechtrix Part Number	Blade Form Diameter		OEM Part Number
		(in)	(mm)	
M-Series Blades are available in 0.1mm increments in the following sizes: KM104NM-0.3 thru KM104NM-4.0	-	-	-	-

KM Digitech KM-104N Full Radius Blades

Mechtrix Description	Mechtrix Part Number	Blade Form Diameter		OEM Part Number
		(in)	(mm)	
Full Radius Blades are available in 0.1mm increments in the following sizes: KM104N-0.4D thru KM104N-4.0D	-	-	-	-

Misc. Blades and Tooling

KMI Stripping Blades

Used In These Machines

KMI
Junior
Contact ST
Contact ST5
Contact DWF 5
Contact TR
Extreme

The KMI Machines use "Universal" Style Stripping Blades to remove the insulation from the end of a wire. Mechtrix blades for the KMI Machines are made to precision standards from a specially selected tool steel to insure optimum performance and blade life and are produced using state-of-the-art manufacturing techniques. The state-of-the-art manufacturing techniques are combined with patented Mechtrix technology to produce perfect stripping form radii.

In addition to the "Universal" Stripping Blades, Mechtrix also offers both our patented M-Series and Full Radius stripping form geometries for processing difficult insulations in the KMI Machines. Please contact Mechtrix for assistance in selecting the appropriate style and size blade for your particular application.

KMI Universal Blades



Mechtrix Description	Mechtrix Part Number	Blade Form Diameter		OEM Part Number
		(in)	(mm)	
KMI Universal Strip/Cut Blades (Carbide)	17893-01	-	-	T2AB0017V
KMI Universal Strip/Cut Blades (M2)	17893-03	-	-	T2AB0017
KMI Universal Strip/Cut Blades w/TiN Coating (M2)	17893-03-CT1	-	-	T2AB0017R
KMI Universal Cut-off Blades w/TiN Coating (Carbide)	26929-01-CT1	-	-	AB000365
KMI Universal Cut-off Blades w/TiN Coating (A2)	26929-04-CT1	-	-	-



KMI M-Series Blades

Mechtrix Description	Mechtrix Part Number	Blade Form Diameter		OEM Part Number
		(in)	(mm)	
M-Series Blades are available in 0.1mm increments in the following sizes: KMIM-0.3 thru KMIM-4.0	-	-	-	-



KMI Full Radius Blades

Mechtrix Description	Mechtrix Part Number	Blade Form Diameter		OEM Part Number
		(in)	(mm)	
Full Radius Blades are available in 0.1mm increments in the following sizes: KMI-0.4D thru KMI-4.0D	-	-	-	-

Misc. Blades and Tooling

Kormak Wire Processing Machines

Used In These
Machines

Kormak
All Models

Mechtrix offers a complete line of die-type blades and guides for the Kormak Wire Stripping Machine. Mechtrix Stripping Blades for the Kormak Machines are made to precision standards from a specially selected tool steel to insure optimum performance and blade life and are produced using state-of-the-art manufacturing techniques. Mechtrix Kormak Stripping Blades have the Mechtrix patented feature of a cutting form which includes a perfectly formed cutting radius.

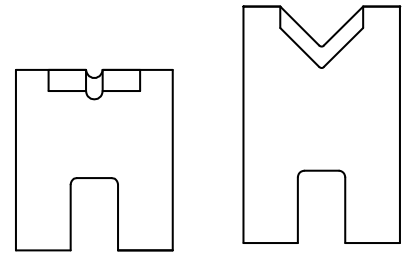

The stripping blades for the Kormak Machines are designated by the prefix KKD and are available in 0.1mm radii increments from KKD-0.4 thru KKD-10.8. The wire guides are designated by the prefix KKDG and are also available in 0.1mm increments from KKDG-0.5 thru KKDG-12.4. For specific sizing information please contact Mechtrix.

Kut-Rite Wire Processing Machines

Used In These
Machines

Kut-Rite
All Models

The Kut-Rite Wire Processing Machines use the standard Artos Wire Processing Tooling. These blades can be found in the Artos Tooling section of this catalog and include the "V", "WV", "WWV", "M", "ID" and "WID" Series Stripping Blades.

Please contact Mechtrix for assistance in selecting the appropriate style and size blade for your particular application.

Makfil Wire Processing Machines

Used In These
Machines

Makfil
All Models

Mechtrix offers a complete line of die-type blades and guides for most of the Makfil Wire Processing Machines. Mechtrix Stripping Blades for the Makfil Machines are made to precision standards from a specially selected tool steel to insure optimum performance and blade life and are produced using state-of-the-art manufacturing techniques. Mechtrix Makfil Stripping Blades include the Mechtrix patented feature of a cutting form which includes a perfectly formed cutting radius.

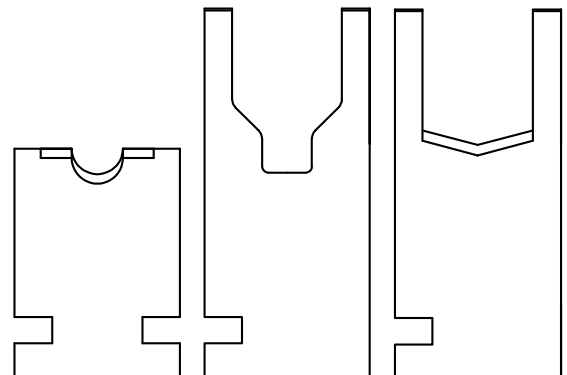

The stripping blades for the Makfil Machines are designated by the prefix MFD and are available in 0.1mm radii increments from MFD-0.4 thru MFD-10.8. The wire guides are designated by the prefix MFDG and are also available in 0.1mm increments from MFDG-0.5 thru MFDG-12.4. For specific sizing information please contact Mechtrix.



Mechtrix Corporation • W147 N9461 Held Drive • Menomonee Falls, WI 53051
Tel (262) 255-6555 • Fax (262) 255-2628 • Website <http://www.mechtrix.com>

Misc. Blades and Tooling

MCM Cosmic 30M Stripping Blades

Used In These Machines

MCM Cosmic Cosmic 30M

The MCM Cosmic 30M Machine is supplied with a set of (4) "Universal" Stripping Blades to remove the insulation from the end of a wire. Mechtrix replacement blades for the MCM Cosmic 30M Machines utilize our own (2) piece design to reduce cost and improve performance.

In addition to our own "Universal" Stripping Blades, Mechtrix also offers both our patented M-Series and Full Radius stripping form geometries for processing difficult insulations in the MCM Cosmic 30M Machine. Please contact Mechtrix for assistance in selecting the appropriate style and size blade for your particular application.

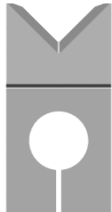

Cosmic 30M Universal Blades

Mechtrix Description	Mechtrix Part Number	Blade Form Diameter		OEM Part Number
		(in)	(mm)	
Cosmic 30M Universal Strip Blade (2 pc. Design)	28719	-	-	C32530 9-547951-0

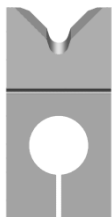

Cosmic 30M M-Series Blades

Mechtrix Description	Mechtrix Part Number	Blade Form Diameter		OEM Part Number
		(in)	(mm)	
M-Series Blades are available in 0.1mm increments in the following sizes: C30MM-0.3 thru C30MM-5.0	-	-	-	-

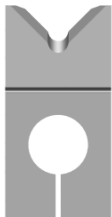

Cosmic 30M Full Radius Blades

Mechtrix Description	Mechtrix Part Number	Blade Form Diameter		OEM Part Number
		(in)	(mm)	
Full Radius Blades are available in 0.1mm increments in the following sizes: C30-0.4D thru C30-5.0D	-	-	-	-

A set of Mechtrix Blades for the Komax Cosmic 30M consists of two (2) strip blades.

Misc. Blades and Tooling

MCM Cosmic 32M and Komax Delta 50

Used In These
Machines

MCM Cosmic
Cosmic 32M
Komax Delta 50

The MCM Cosmic 32M and Komax Delta 50 Machines use a single set of "Universal" Stripping Blades to remove the insulation from the end of a wire. Mechtrix blades for the MCM Cosmic 32M and Komax Delta 50 Machines are made to precision standards from a specially selected tool steel to insure optimum performance and blade life.

In addition to the "Universal" Stripping Blades, Mechtrix also offers both our patented M-Series and Full Radius stripping form geometries for processing difficult insulations in the MCM Cosmic 32M and Komax Delta 50. Please contact Mechtrix for assistance in selecting the appropriate style and size blade for your particular application.



Cosmic 32M & Komax Delta 50 Universal Blades

Mechtrix Description	Mechtrix Part Number	Blade Form Diameter		OEM Part Number
		(in)	(mm)	
Komax K50-U Universal Strip Blade	23166	-	-	047894 C21211 3-547217-5



Cosmic 32M & Komax Delta 50 M-Series Blades

Mechtrix Description	Mechtrix Part Number	Blade Form Diameter		OEM Part Number
		(in)	(mm)	
M-Series Blades are available in 0.1mm increments in the following sizes: K50M-0.3 thru K50M-5.0	-	-	-	-



Cosmic 32M & Komax Delta 50 Full Radius Blades

Mechtrix Description	Mechtrix Part Number	Blade Form Diameter		OEM Part Number
		(in)	(mm)	
Full Radius Blades are available in 0.1mm increments in the following sizes: K50-0.4D thru K50-5.0D	-	-	-	-

A set of blades for the Cosmic 32M & Komax Delta 50 consists of two (2) pieces.

Misc. Blades and Tooling

MCM Cosmic 60R & Komax Delta 60 Stripping Blades

Used In These
Machines

MCM Cosmic
Cosmic 60R
Komax Delta 60



The MCM Cosmic 60R and Komax Delta 60 Machines use a single set of "Universal" Stripping Blades to remove the insulation from the end of a wire. Mechtrix blades for the MCM Cosmic 60R and Komax Delta 60 Machines are made to precision standards from a specially selected tool steel to insure optimum performance and blade life.

Cosmic 60R & Komax Delta 60 Universal Blades

Mechtrix Description	Mechtrix Part Number	Blade Form Diameter		OEM Part Number
		(in)	(mm)	
Komax K60 Universal Strip Blade	23812	-	-	51589 C60112 3-547217-0

A set of blades for the Cosmic 60R & Komax Delta 60 consists of two (2) pieces.

MCM Cosmic 927R Stripping Blades

Used In These
Machines

MCM Cosmic
Cosmic 927R

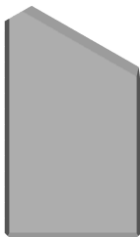

The MCM Cosmic 927R Machine use a single set of "Universal" Stripping Blades to remove the insulation from the end of a wire. Mechtrix blades for these MCM Cosmic Machines are made to precision standards from a specialty micro-grain carbide to insure optimum performance and blade life. State-of-the-art manufacturing techniques are combined with Mechtrix grinding technology creates precision ground stripping form edges which in turn produce the highest quality cutting tool possible.

Cosmic 927R Universal Blades

Mechtrix Description	Mechtrix Part Number	Blade Form Diameter		OEM Part Number
		(in)	(mm)	
Cosmic 927R Universal Strip Blade	28951-CT1	-	-	C65032 9-547951-2

A set of Mechtrix Blades for the MCM Cosmic 927R consists of two (2) strip blades.

Misc. Blades and Tooling

Mecal SC10, SC11 and SC12 Stripper/Crimper Machines

Used In These Machines

Mecal
SC10
SC11
SC12

The Mecal SC10, SC11 and SC12 Stripper/Crimper Machines use a single set of V-Style Stripping Blades to remove the insulation from the end of a wire. Mechtrix blades for the Mecal Machines are made to precision standards from a specially selected tool steel to insure optimum performance and blade life and are produced using state-of-the-art manufacturing techniques.



In addition to the V-Style Stripping Blades, Mechtrix also offers Full Radius stripping form geometries for processing difficult insulations in the Mecal Machines. Please contact Mechtrix for assistance in selecting the appropriate style and size blade for your particular application.

Mecal SC10/SC11/SC12 Stripping Blades

Mechtrix Description	Mechtrix Part Number	Blade Form Diameter		OEM Part Number
		(in)	(mm)	
SC10/SC11/SC12-0.2 Stripper/Crimper Blade (R0.1)	26447	0.00787	0.2	791130021
SC10/SC11/SC12-0.7 Stripper/Crimper Blade (R0.35)	26448	0.02756	0.7	791130014
SC10/SC11/SC12-1.0 Stripper/Crimper Blade (R0.5)	25611	0.03937	1.0	791130011
SC10/SC11/SC12-1.5 Stripper/Crimper Blade (R0.75)	17377	0.05906	1.5	791130020
SC10/SC11/SC12-2.0 Stripper/Crimper Blade (R1.0)	26449	0.07874	2.0	791130015
SC10/SC11/SC12-3.0 Stripper/Crimper Blade (R1.5)	26450	0.11811	3.0	791130016
SC10/SC11/SC12-4.0 Stripper/Crimper Blade (R2.0)	26451	0.15748	4.0	791130017

Mecal SC10/SC11/SC12 Full Radius Blades

Mechtrix Description	Mechtrix Part Number	Blade Form Diameter		OEM Part Number
		(in)	(mm)	
Full Radius Blades are available in 0.1mm increments in the following sizes: SC10/11/12-0.4D thru SC10/11/12-4.0D	-	-	-	-

Mecal SC19 Stripper/Crimper Machines

Used In These Machines

Mecal
SC19

The Mecal SC19 Stripper/Crimper Machines use a single set of V-Style Stripping Blades to remove the insulation from the end of a wire. Mechtrix blades for the Mecal Machines are made to precision standards from a specially selected tool steel to insure optimum performance and blade life and are produced using state-of-the-art manufacturing techniques.



Mecal SC19 Stripping Blades

Mechtrix Description	Mechtrix Part Number	Blade Form Diameter		OEM Part Number
		(in)	(mm)	
SC19 Stripper/Crimper Blade-Fixed (R0.55)	26942	0.04331	1.1	791110014
SC19 Stripper/Crimper Blade-Moving (R0.55)	26943			791130024

Misc. Blades and Tooling

Metzner Wire Processing Machines

Used In These
Machines

Metzner
All Models

Mechtrix offers a complete line of die-type blades and guides for both the standard and large cable Metzner Wire Processing Machines. Mechtrix Stripping Blades for the Metzner Machines are made to precision standards from a specially selected tool steel to insure optimum performance and blade life and are produced using state-of-the-art manufacturing techniques. Mechtrix Metzner Stripping Blades include the Mechtrix patented feature of a cutting form which includes a perfectly formed cutting radius.

The stripping blades for the standard Metzner Wire Stripping Machines are designated by the prefix MBD and are available in 0.1mm radii increments from MBD-0.4 thru MBD-10.8. The wire guides are designated by the prefix MBDG and are also available in 0.1mm increments from MBDG-0.5 thru MBDG-12.4. For specific sizing information please contact Mechtrix.

The stripping blades for the large Metzner Wire Stripping Machines (30mm wide) are designated by the prefix MBDE and are available in 0.1mm radii increments from MBDE-0.4 thru MBDE-20.0. The wire guides are designated by the prefix MBDG and are also available in 0.1mm increments from MBDGE-0.5 thru MBDGE-23.0. For specific sizing information please contact Mechtrix.

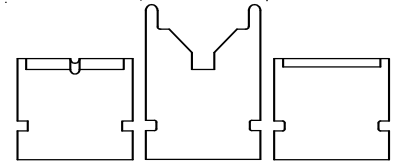
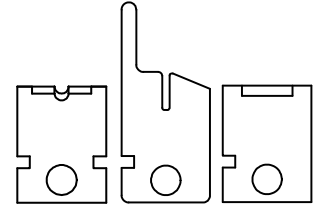

Misc. Blades and Tooling

PAWO B12, B16 and B21 Stripper/Crimper Machines

Used In These Machines

PAWO
B12
B16
B21



The PAWO/Schleuniger B12, B16 and B21 Stripper/Crimper Machines use a single set of V-Style Stripping Blades to remove the insulation from the end of a wire. Mechtrix blades for the PAWO/Schleuniger Machines are made to precision standards from a specially selected tool steel to insure optimum performance and blade life and are produced using state-of-the-art manufacturing techniques.

In addition to the V-Style Stripping Blades, Mechtrix also offers Full Radius stripping form geometries for processing difficult insulations in the PAWO/Schleuniger Machines. Please contact Mechtrix for assistance in selecting the appropriate style and size blade for your particular application.

PAWO B12/B16/B21 V-Style Stripping Blades

Mechtrix Description	Mechtrix Part Number	Blade Form Diameter		OEM Part Number
		(in)	(mm)	
PAWO B16-X.XL Stripper/Crimper Blade-Long	-	-	-	1634303XXXX
PAWO B16-X.XS Stripper/Crimper Blade-Short	-	-	-	1604087XXXX
Please contact Mechtrix for specific part number (XXXX = Stripping Blade Form Radius In mm)				

PAWO B12/B16/B21 Full Radius Stripping Blades

Mechtrix Description	Mechtrix Part Number	Blade Form Diameter		OEM Part Number
		(in)	(mm)	
PAWO B16-X.XDL Stripper/Crimper Blade-Long	-	-	-	1634431XXXX
PAWO B16-X.XDS Stripper/Crimper Blade-Short	-	-	-	1626735XXXX
Please contact Mechtrix for specific part number (XXXX = Stripping Blade Form Diameter In mm)				

PAWO/Schleuniger Servo Stripper Machines

Used In These Machines

PAWO
Servo Stripper

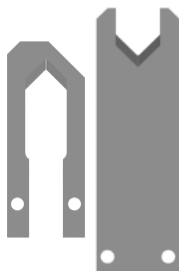

The PAWO/Schleuniger Servo Stripper Machines use a single set of V-Style Stripping Blades to remove the insulation from the end of a wire. Mechtrix blades for the PAWO/Schleuniger Machines are made to precision standards from a specially selected tool steel to insure optimum performance and blade life and are produced using state-of-the-art manufacturing techniques.

PAWO Servo Stripper V-Style Stripping Blades

Mechtrix Description	Mechtrix Part Number	Blade Form Diameter		OEM Part Number
		(in)	(mm)	
PAWO Servo Stripper Blade-A (R0.3)	31228	0.02362	0.6	50400870030
PAWO Servo Stripper Blade-B (R0.3)	31229			50810810030
PAWO Servo Stripper Blade-A (R0.6)		0.04724	1.2	50400870060
PAWO Servo Stripper Blade-B (R0.6)				50810810060
Please contact Mechtrix for specific part number (XXXX = Stripping Blade Form Radius In mm)				

Misc. Blades and Tooling

ShinMaywa TR10/TR20/TR30 and THR20/THR30 Machines

Used In These Machines

Shin Maywa
TR10/TR20/TR30
THR20/THR30

The ShinMaywa Wire Processing Machines use a set of Stripping Blades to remove the insulation from the end of a wire. Mechtrix blades for the ShinMaywa Machines are made to precision standards from either specially selected tool steel or tungsten carbide. State-of-the-art manufacturing techniques, combined with patented Mechtrix technology, produce perfect stripping form radii that insure both optimum performance and blade life.

In addition to the "Universal" and "V-Style" Stripping Blades, Mechtrix also offers our patented M-Series and Full Radius stripping form geometries for processing difficult insulations in the Shin Maywa Machines. Please contact Mechtrix for assistance in selecting the appropriate style and size blade for your particular application.

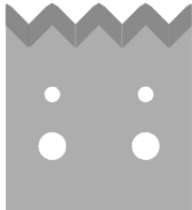

TR10/TR20/TR30 and THR20/THR30 Universal Blades

Mechtrix Description	Mechtrix Part Number	Blade Form Diameter		OEM Part Number
		(in)	(mm)	
SM4 Universal Stripping Blade	03569-02	-	-	H92789-A
SM4 Universal Stripping Blade-Carbide	03569-04	-	-	-

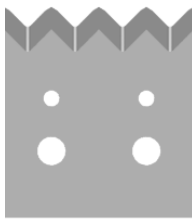

TR10/TR20/TR30 and THR20/THR30 V-Style Blades

Mechtrix Description	Mechtrix Part Number	Blade Form Diameter		OEM Part Number
		(in)	(mm)	
SM4V90-0.5 Stripping Blade	20000-02	0.01969	0.50	-
SM4V90-0.7 Stripping Blade	32042-02	0.02756	0.70	-
SM4V90-1.0 Stripping Blade	32043-02	0.03937	1.00	-
SM4V90-1.2 Stripping Blade	28245-02	0.04724	1.20	-
SM4V90-1.6 Stripping Blade	32044-02	0.06299	1.60	-
Addition V-Style Blades are available in 0.1mm increments in the following sizes: SM4V90-0.3 thru SM4V90-3.0				

Misc. Blades and Tooling

ShinMaywa TR111/TR201/TR202 and TRD111/TRD301/TRD302 Machines

Used In These Machines

- ShinMaywa
- TR111
- TR201
- TR202
- TRD111
- TRD301
- TRD302

The ShinMaywa Wire Processing Machines use a set of Stripping Blades to remove the insulation from the end of a wire. Mechtrix blades for the ShinMaywa Machines are made to precision standards from either specially selected tool steel or tungsten carbide. State-of-the-art manufacturing techniques, combined with patented Mechtrix technology, produce perfect stripping form radii that insure both optimum performance and blade life.

In addition to the "Universal" and "V-Style" Stripping Blades, Mechtrix also offers our patented M-Series and Full Radius stripping form geometries for processing difficult insulations in the Shin Maywa Machines. Please contact Mechtrix for assistance in selecting the appropriate style and size blade for your particular application.

TR111/TR201/TR202 and TRD111/TRD301/TRD302 Universal Blades

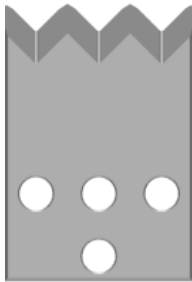

Mechtrix Description	Mechtrix Part Number	Blade Form Diameter		OEM Part Number
		(in)	(mm)	
SM3 Universal Stripping Blade (30°)	21031-03	-	-	H92789-A P16307-A P35966-A
SM3 Universal Stripping Blade w/TiN Coating (30°)	21031-03-CT1	-	-	P16307-B P35966-B
SM3 Universal Stripping Blade-Carbide (30°)	21031-01	-	-	P17347-A
SM3 Universal Stripping Blade (20°)	32085-03	-	-	N71019-B N71264-A P36152-A
SM3 Universal Stripping Blade w/TiN Coating (20°)	32085-03-CT1	-	-	N71264-B P36152-B
SM3 Universal Stripping Blade (15°)	32041-03	-	-	N71019-A

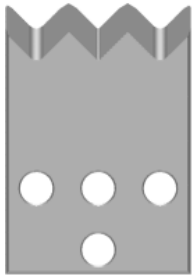

TR111/TR201/TR202 and TRD111/TRD301/TRD302 V-Style Blades (20°)

Mechtrix Description	Mechtrix Part Number	Blade Form Diameter		OEM Part Number
		(in)	(mm)	
SM3V-0.2 Stripping Blade (20°)	32118-03	0.00787	0.20	N70912-A
SM3V-0.3 Stripping Blade (20°)	32119-03	0.01181	0.30	N70912-B
SM3V-0.4 Stripping Blade (20°)	32120-03	0.01575	0.40	N70912-C
SM3V-0.5 Stripping Blade (20°)	32121-03	0.01969	0.50	N70912-D
SM3V-0.6 Stripping Blade (20°)	32122-03	0.02362	0.60	N70912-E
SM3V-1.7 Stripping Blade (20°)	32123-03	0.06693	1.70	N71520-A
SM3V-1.8 Stripping Blade (20°)	32124-03	0.07087	1.80	N71520-B
Addition V-Style Blades are available in 0.1mm increments in the following sizes: SM3V-0.3 thru SM3V-3.0				

Misc. Blades and Tooling

ShinMaywa TR111/TR201/TR202 and TRD111/TRD301/TRD302 Machines

Used In These
Machines

ShinMaywa
TR111
TR201
TR202
TRD111
TRD301
TRD302

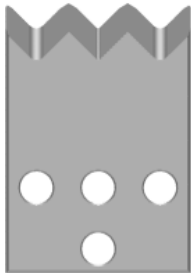

The ShinMaywa Wire Processing Machines use a set of Stripping Blades to remove the insulation from the end of a wire. Mechtrix blades for the ShinMaywa Machines are made to precision standards from either specially selected tool steel or tungsten carbide. State-of-the-art manufacturing techniques, combined with patented Mechtrix technology, produce perfect stripping form radii that insure both optimum performance and blade life.

TR111/TR201/TR202 and TRD111/TRD301/TRD302 V-Style Blades (30°)

Mechtrix Description	Mechtrix Part Number	Blade Form Diameter		OEM Part Number
		(in)	(mm)	
SM3V-0.7 Stripping Blade (30°)	32045-03	0.02756	0.70	MS070CA NC0224-A
SM3V-0.9 Stripping Blade (30°)	32050-03	0.03543	0.90	L49700-A MS090CA NC0224-B
SM3V-1.0 Stripping Blade (30°)	32102-03	0.03937	1.00	-
SM3V-1.1 Stripping Blade (30°)	32051-03	0.04331	1.10	L49700-B MS110CA NC0224-C
SM3V-1.2 Stripping Blade (30°)	32103-03	0.04724	1.20	-
SM3V-1.3 Stripping Blade (30°)	32052-03	0.05118	1.30	L49702-C MS130CA NC0224-D
SM3V-1.4 Stripping Blade (30°)	32104-03	0.05512	1.40	
SM3V-1.5 Stripping Blade (30°)	32053-03	0.05906	1.50	MS150CA NC0224-E
SM3V-1.6 Stripping Blade (30°)	32105-03	0.06299	1.60	L49703-D
SM3V-1.7 Stripping Blade (30°)	32106-03	0.06693	1.70	-
SM3V-1.8 Stripping Blade (30°)	32054-03	0.07087	1.80	MS180CA NC0224-F
SM3V-1.9 Stripping Blade (30°)	32107-03	0.07480	1.90	-
SM3V-2.0 Stripping Blade (30°)	32055-03	0.07874	2.00	MS200CA NC0224-G
SM3V-2.2 Stripping Blade (30°)	32056-03	0.08661	2.20	L49704-E MS220CA NC0224-H
SM3V-2.4 Stripping Blade (30°)	32057-03	0.09449	2.40	L49704-F MS240CA NC0224-J
SM3V-2.6 Stripping Blade (30°)	32108-03	0.10236	2.60	-
SM3V-2.8 Stripping Blade (30°)	32109-03	0.11024	2.80	-
SM3V-3.0 Stripping Blade (30°)	32058-03	0.11811	3.00	MS300CA NC0224-K

Addition V-Style Blades are available in 0.1mm increments in the following sizes:
SM3V-0.3 thru SM3V-3.0

Misc. Blades and Tooling

ShinMaywa TR111/TR201/TR202 and TRD111/TRD301/TRD302 Machines

Used In These Machines

ShinMaywa
TR111
TR201
TR202
TRD111
TRD301
TRD302

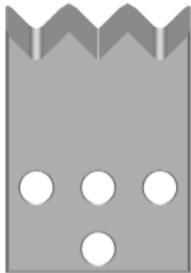

The ShinMaywa Wire Processing Machines use a set of Stripping Blades to remove the insulation from the end of a wire. Mechtrix blades for the ShinMaywa Machines are made to precision standards from either specially selected tool steel or tungsten carbide. State-of-the-art manufacturing techniques, combined with patented Mechtrix technology, produce perfect stripping form radii that insure both optimum performance and blade life.

TR111/TR201/TR202 and TRD111/TRD301/TRD302 90° V-Style Blades (30°)

Mechtrix Description	Mechtrix Part Number	Blade Form Diameter		OEM Part Number
		(in)	(mm)	
SM3V90-0.5 Stripping Blade (30°)	32018-03	0.01969	0.50	NC0002-A NC0018-A
SM3V90-1.0 Stripping Blade (30°)	32019-03	0.03937	1.00	NC0002-B NC0018-B
SM3V90-1.2 Stripping Blade (30°)	32020-03	0.04724	1.20	-
SM3V90-1.4 Stripping Blade (30°)	32021-03	0.05512	1.40	-
SM3V90-1.5 Stripping Blade (30°)	28243-03	0.05906	1.50	NC0002-C NC0018-C
SM3V90-1.6 Stripping Blade (30°)	32022-03	0.06299	1.60	-
SM3V90-1.7 Stripping Blade (30°)	32023-03	0.06693	1.70	-
SM3V90-1.9 Stripping Blade (30°)	32024-03	0.07480	1.90	-
SM3V90-2.0 Stripping Blade (30°)	32025-03	0.07874	2.00	NC0002-D NC0018-D
SM3V90-2.4 Stripping Blade (30°)	28244-03	0.09449	2.40	-
SM3V90-2.6 Stripping Blade (30°)	32026-03	0.10236	2.60	-
SM3V90-2.8 Stripping Blade (30°)	32027-03	0.11024	2.80	-
SM3V90-3.0 Stripping Blade (30°)	32028-03	0.11811	3.00	NC0002-E NC0018-E
Addition V-Style Blades are available in 0.1mm increments in the following sizes: SM3V90-0.3 thru SM3V90-3.0				

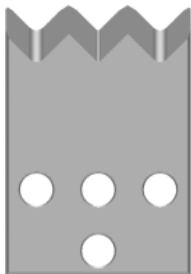

TR111/TR201/TR202 and TRD111/TRD301/TRD302 V-Blades w/Ø2.0 Cut-off

Mechtrix Description	Mechtrix Part Number	Blade Form Diameter		OEM Part Number
		(in)	(mm)	
SM3V-0.9 Strip Blade (30°) w/Ø2.0 Cut-off	32110-03	0.03543	0.90	NC0383-A
SM3V-1.1 Strip Blade (30°) w/Ø2.0 Cut-off	32111-03	0.04331	1.10	NC0383-B
SM3V-1.3 Strip Blade (30°) w/Ø2.0 Cut-off	32112-03	0.05118	1.30	NC0383-C
SM3V-1.6 Strip Blade (30°) w/Ø2.0 Cut-off	32113-03	0.06299	1.60	NC0383-D
SM3V-1.8 Strip Blade (30°) w/Ø2.0 Cut-off	32117-03	0.07087	1.80	NC0383-H
SM3V-2.2 Strip Blade (30°) w/Ø2.0 Cut-off	32114-03	0.08661	2.20	NC0383-E
SM3V-3.0 Strip Blade (30°) w/Ø2.0 Cut-off	32115-03	0.11811	3.00	NC0383-F
SM3V-3.5 Strip Blade (30°) w/Ø2.0 Cut-off	32116-03	0.13780	3.50	NC0383-G
Addition V-Style Blades are available in 0.1mm increments in the following sizes: SM3V-0.3 thru SM3V-3.0				

Misc. Blades and Tooling

ShinMaywa TR111/TR201/TR202 and TRD111/TRD301/TRD302 Machines

Used In These
Machines

In addition to the "Universal" and "V-Style" Stripping Blades, Mechtrix also offers our patented M-Series and Full Radius stripping form geometries for processing difficult insulations in the Shin Maywa Machines. Please contact Mechtrix for assistance in selecting the appropriate style and size blade for your particular application.

ShinMaywa

TR111
TR201
TR202
TRD111
TRD301
TRD302

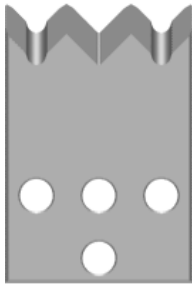

TR111/TR201/TR202 and TRD111/TRD301/TRD302 M-Series Blades

Mechtrix Description	Mechtrix Part Number	Blade Form Diameter		OEM Part Number
		(in)	(mm)	
SM3M-0.9 Stripping Blade (20°)	32059-03	0.03543	0.90	3090 L48755-A
SM3M-1.1 Stripping Blade (20°)	32060-03	0.04331	1.10	3110 L48755-B
SM3M-1.3 Stripping Blade (20°)	32061-03	0.05118	1.30	3130 L48755-C
SM3M-1.5 Stripping Blade (20°)	32062-03	0.05906	1.50	3150 L48755-D
SM3M-1.8 Stripping Blade (20°)	32063-03	0.07087	1.80	3180 L48755-E
SM3M-2.0 Stripping Blade (20°)	32064-03	0.07874	2.00	3200 L48755-F
SM3M-2.2 Stripping Blade (20°)	32065-03	0.08661	2.20	3220 L48755-G
SM3M-2.4 Stripping Blade (20°)	32066-03	0.09449	2.40	3240 L48755-H
SM3M-3.0 Stripping Blade (20°)	32067-03	0.11811	3.00	3300 L48755-J
Additional M-Series Blades are available in 0.1mm increments in the following sizes: SMM-0.3 thru SMM-3.0				

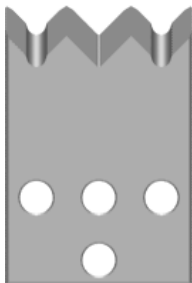

TR111/TR201/TR202 and TRD111/TRD301/TRD302 Full Radius Blades

Mechtrix Description	Mechtrix Part Number	Blade Form Diameter		OEM Part Number
		(in)	(mm)	
SM3-0.8D Stripping Blade (30°)	32029-03	0.03150	0.80	-
SM3-0.9D Stripping Blade (30°)	32030-03	0.03543	0.90	-
SM3-1.0D Stripping Blade (30°)	32031-03	0.03937	1.00	-
SM3-1.1D Stripping Blade (30°)	32032-03	0.04331	1.10	-
SM3-1.2D Stripping Blade (30°)	32033-03	0.04724	1.20	-
SM3-1.3D Stripping Blade (30°)	32034-03	0.05118	1.30	-
SM3-1.4D Stripping Blade (30°)	32035-03	0.05512	1.40	-
SM3-1.5D Stripping Blade (30°)	32036-03	0.05906	1.50	-
SM3-1.6D Stripping Blade (30°)	32037-03	0.06299	1.60	-
SM3-1.7D Stripping Blade (30°)	32038-03	0.06693	1.70	-
SM3-1.8D Stripping Blade (30°)	32039-03	0.07087	1.80	-
SM3-1.9D Stripping Blade (30°)	32040-03	0.07480	1.90	-
Additional Full Radius Blades are available in 0.1mm increments in the following sizes: SM3-0.3D thru SM3-3.0D				



Mechtrix Corporation • W147 N9461 Held Drive • Menomonee Falls, WI 53051
Tel (262) 255-6555 • Fax (262) 255-2628 • Website <http://www.mechtrix.com>

Misc. Blades and Tooling

ShinMaywa TR111/TR201/TR202 and TRD111/TRD301/TRD302 Machines

Used In These Machines

- ShinMaywa
- TR111
- TR201
- TR202
- TRD111
- TRD301
- TRD302

The ShinMaywa Wire Processing Machines use a set of Stripping Blades to remove the insulation from the end of a wire. Mechtrix blades for the ShinMaywa Machines are made to precision standards from either specially selected tool steel or tungsten carbide. State-of-the-art manufacturing techniques, combined with patented Mechtrix technology, produce perfect stripping form radii that insure both optimum performance and blade life.

TR111/TR201/TR202 and TRD111/TRD301/TRD302 Strip/Slit Blades

Mechtrix Description	Mechtrix Part Number	Blade Form Diameter		OEM Part Number
		(in)	(mm)	
SM3S-1.0 Stripping Blade w/Slit Position	25526-03	0.03937	1.00	MS110C
SM3S-1.2 Stripping Blade w/Slit Position	25527-03	0.04724	1.20	MS130C
SM3S-1.5 Stripping Blade w/Slit Position	25528-03	0.05906	1.50	MS150C
SM3S-2.2 Stripping Blade w/Slit Position	25529-03	0.08661	2.20	MS220C
SM3SK-D Slitting Blade	25533	-	-	-
Additional Strip/Slit Blades are available in 0.1mm increments in the following sizes: SM3S-0.3 thru SM3S-3.0				

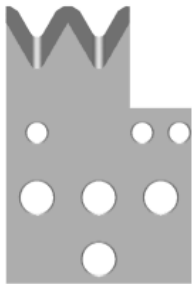

Misc. Blades and Tooling

Tekuwa/Dorema Wire Processing Machines

Used In These
Machines

Tekuwa/Dorema
All Models

Mechtrix offers a complete line of die-type blades and guides for the Tekuwa/Dorema Wire Stripping Machine. Mechtrix Stripping Blades for the Tekuwa/Dorema Machines are made to precision standards from a specially selected tool steel to insure optimum performance and blade life and are produced using state-of-the-art manufacturing techniques. Mechtrix Tekuwa/Dorema Stripping Blades have the Mechtrix patented feature of a cutting form which includes a perfectly formed cutting radius.

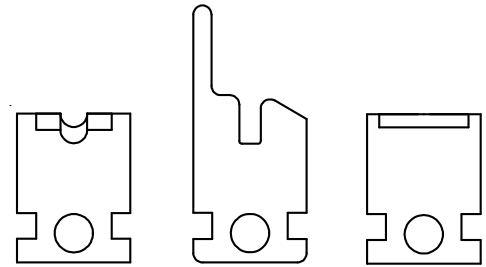

The stripping blades for the Tekuwa/Dorema Machines are designated by the prefix DD and are available in 0.1mm radii increments from DD-0.4 thru DD-10.8. The wire guides are designated by the prefix DDG and are also available in 0.1mm increments from DDG-0.5 thru DDG-12.4. For specific sizing information please contact Mechtrix.

Misc. Blades and Tooling

Yazaki Wire Processing Machines

Used In These Machines

Yazaki
YACC-4
YACC-6
YACC-7
YACC-8
Nakahagi CS-20
Yazaki SS10

Mechtrix offers a number of different styles of stripping and cut-off blades for the various wire processing machines manufactured by Yazaki. Some of the more popular sizes and style are listed below. Mechtrix blades for the Yazaki Machines are made to precision standards from a specially selected tool steel to insure optimum performance and blade life and are produced using state-of-the-art manufacturing techniques. The state-of-the-art manufacturing techniques are combined with patented Mechtrix technology to produce perfect stripping form radii.

In addition to the "Universal" Stripping Blades, Mechtrix also offers our patented M-Series stripping form geometries for processing difficult insulations in the Yazaki Machines. Please contact Mechtrix for assistance in selecting the appropriate style and size blade for your particular application.



YACC-4 Stripping and Cut-off Blades

Mechtrix Description	Mechtrix Part Number	Wire Range	OEM Part Number
Y4V-0.3-0.5 Strip Blade	24844-CT1	0.3~0.5mm ²	-
Y4V-0.5-2.0 Strip Blade	24845-CT1	0.5~2.0mm ²	-
Y4V-3.0-8.0 Strip Blade	24846-CT1	3.0~8.0mm ²	-
Y4V-3.0 Strip Blade	26194-CT1	3.0mm ²	-
Y4CL Cut-off Blade (WCB)	24847-CT1	-	-



YACC-4 Off-Set Stripping Blades

Mechtrix Description	Mechtrix Part Number	Wire Range	OEM Part Number
Y4OV-0.5-2.0 (Off-set) Strip Blade	25790-CT1	0.5~2.0mm ²	-
Y4OV-0.3-0.5 (Off-set) Strip Blade	25789-CT1	0.3~0.5mm ²	-
Y4OV-0.3-1.25 (Off-set) Strip Blade	25791-CT1	0.3~1.25mm ²	-

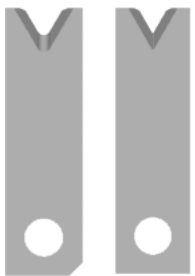

YACC-6 and YACC-7 Stripping and Cut-off Blades

Mechtrix Description	Mechtrix Part Number	Wire Range	OEM Part Number
Y6V-A05 Strip Blade (A05)	21523-CT1	0.3~0.85mm ²	
Y6V-B05 Strip Blade (B05)	21524-CT1		
Y6V-A06 Strip Blade (A06)	25779-CT1	0.85mm ²	
Y6V-B06 Strip Blade (B06)	25780-CT1		
Y6V-A07 Strip Blade (A07)	25781-CT1	1.25mm ²	
Y6V-B07 Strip Blade (B07)	25782-CT1		
Y6V-A10 Strip Blade (A10)	21525-CT1	1.25~2.0mm ²	
Y6V-B10 Strip Blade (B10)	21526-CT1		
Y6CL Cut-off Blade (1.0mm) (WCB)	21522-CT1	-	

Misc. Blades and Tooling

Yazaki Wire Processing Machines

Used In These Machines

- Yazaki
- YACC-4
- YACC-6
- YACC-7
- YACC-8
- Nakahagi CS-20
- Yazaki SS10

Mechtrix offers a number of different styles of stripping and cut-off blades for the various wire processing machines manufactured by Yazaki. Some of the more popular sizes and style are listed below. Mechtrix blades for the Yazaki Machines are made to precision standards from a specially selected tool steel to insure optimum performance and blade life and are produced using state-of-the-art manufacturing techniques. The state-of-the-art manufacturing techniques are combined with patented Mechtrix technology to produce perfect stripping form radii.

In addition to the "Universal" Stripping Blades, Mechtrix also offers our patented M-Series stripping form geometries for processing difficult insulations in the Yazaki Machines. Please contact Mechtrix for assistance in selecting the appropriate style and size blade for your particular application.



YACC-8 Stripping and Cut-off Blades

Mechtrix Description	Mechtrix Part Number	Wire Range	OEM Part Number
AC807S Strip Blade	25097-CT1	-	-
AC810S Strip Blade	26526-CT1	-	-
AC815S Strip Blade	26527-CT1	-	-
AC8WC Cut-off Blade	25098-CT1	-	-



Nakahagi CS-20 Stripping Blades

Mechtrix Description	Mechtrix Part Number	Wire Range	OEM Part Number
NCS20-2.3S Strip Blade	25783-CT1	-	-
NCS20-2.3L Strip Blade	25784-CT1		-
NCS20-5.8S Strip Blade	25785-CT1	-	-
NCS20-5.8L Strip Blade	25786-CT1		-
NCS20-0.5-1.25S Strip Blade	25787-CT1	0.5~1.25mm ²	-
NCS20-0.5-1.25L Strip Blade	25788-CT1		-



Yazaki SS10 Stripping Blades

Mechtrix Description	Mechtrix Part Number	Wire Range	OEM Part Number
YSS10V-0.3-0.5 Strip Blade	25793-CT1	0.3~0.5mm ²	-
YSS10V-0.5-2.0 Strip Blade	25792-CT1	0.5~2.0mm ²	-